

Fig. 43-211. Fitting the brakeshoe

3. Fit the sleeve. Rotate the output shaft on the auxiliary gearbox while pushing in the sleeve at the same time. Engage low gear. Engage front wheel drive. Fit and tighten up the nut to a torque of 280–300 Nm (28–30 kpm = 202–217 lbftf). If necessary use 2837 on the control mechanism flange.
4. Coat the contact surface of the cover with sealing agent. Screw tight the cover. Fit the parking brake wire in position.
5. Fit the bolts for the rear engine mounts. Remove the jack.

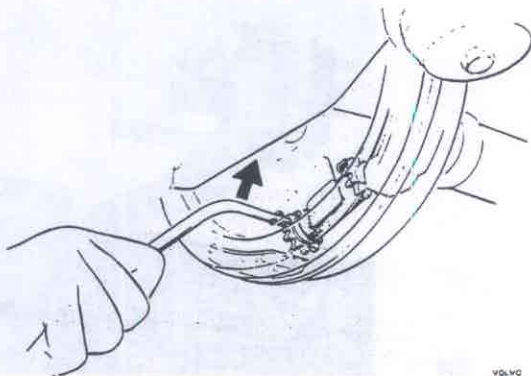

Fig. 43-212. Adjusting brake shoes

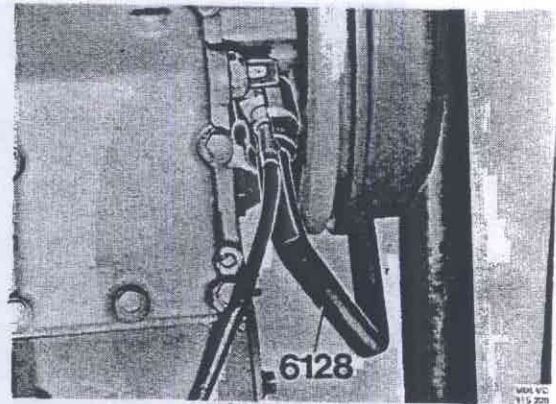

Fig. 43-213. Fitting speedometer wire

6. Assemble the propeller shaft brake. First fit the lower brake shoe. Then the lever (Fig. 43-211), the upper return spring, the upper shoe, the lower return spring and the drum.
7. Adjust out one of the brake shoes with a screwdriver, Fig. 43-212, until it is just possible to rotate the drum. The drum should be fixed with nuts. Slacken the adjuster screw until the drum rotates freely, but max. 5 teeth. Adjust the other brake shoe in the same way.
8. Check the movement of the parking brake lever. If the parking brake does not give full brake application at the 4th–5th ratchet, in spite of the fact that the propeller shaft brake has been properly adjusted, alter the length of the wire with the nut at its front end.
9. Fit the front and rear propeller shafts and tighten the bolts to a torque of 55–65 Nm (5,5–6,5 kpm = 40–47 lbftf). Fit the exhaust manifold. Fill the auxiliary gearbox with oil. Concerning quantity and quality, see under "Data".
10. Remove the hoist eyelet and tighten the cylinder head bolts to a torque of 90 Nm (9 kpm = 66.4 lbftf).
11. Screw tight the speedometer wire with 6128, Fig. 43-213.
12. Fit and connect up the evacuation and vacuum hoses to the control mechanism. Fit and connect up the cable to the sender.
13. Place the lever on the gearbox selector shaft housing and auxiliary gearbox in neutral. The hole in the gearbox lever and the link should coincide in order to make it easier to fit the lock pin, see Fig. 43-214. If necessary, adjust the link fork.

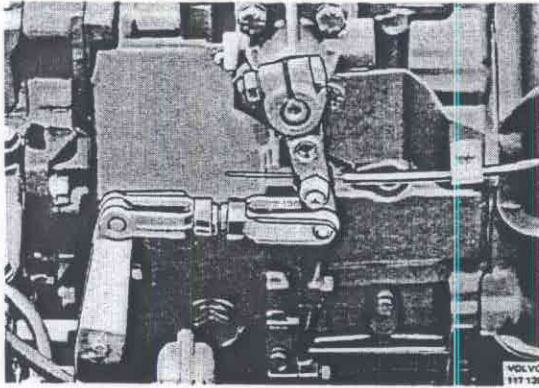
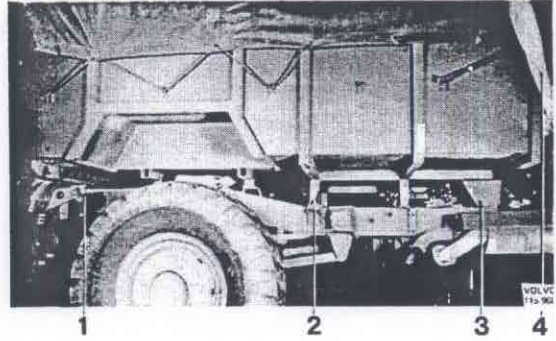

Fig. 43-214. Place the lever

14. Place the wire for the indicator in the gear shaft housing. Turn the indicator arrow to the zero position. Fix the wire to the gear shaft lever, see Fig. 43-214.
15. Place the platform in position, see Fig. 43-215, and tighten up the bolts and U-bolts.
16. Connect the earth connection to the battery and fit the cover.



- | | |
|------------|-----------------|
| 1. Bolting | 3. U-bolts |
| 2. Bolting | 4. Hoist straps |

Fig. 43-215 Fitting the platform

1 Gear
 2 Gear
 3 Gear
 4 Gear
 5 Gear
 6 Gear
 7 Gear
 8 Gear
 9 Gear
 10 Gear
 11 Gear
 12 Gear
 13 Gear
 14 Gear
 15 Gear
 16 Gear
 17 Gear
 18 Gear
 19 Gear
 20 Gear
 21 Gear
 22 Gear
 23 Gear
 24 Gear
 25 Gear
 26 Gear
 27 Gear
 28 Gear
 29 Gear
 30 Gear
 31 Gear
 32 Gear
 33 Gear
 34 Gear
 35 Gear
 36 Gear
 37 Gear
 38 Gear
 39 Gear
 40 Gear
 41 Gear
 42 Gear
 43 Gear
 44 Gear
 45 Gear
 46 Gear
 47 Gear
 48 Gear
 49 Gear
 50 Gear
 51 Gear
 52 Gear
 53 Gear
 54 Gear
 55 Gear
 56 Gear
 57 Gear
 58 Gear
 59 Gear
 60 Gear
 61 Gear
 62 Gear
 63 Gear
 64 Gear
 65 Gear
 66 Gear
 67 Gear
 68 Gear
 69 Gear
 70 Gear
 71 Gear
 72 Gear
 73 Gear
 74 Gear
 75 Gear
 76 Gear
 77 Gear
 78 Gear
 79 Gear
 80 Gear
 81 Gear
 82 Gear
 83 Gear
 84 Gear
 85 Gear
 86 Gear
 87 Gear
 88 Gear
 89 Gear
 90 Gear
 91 Gear
 92 Gear
 93 Gear
 94 Gear
 95 Gear
 96 Gear
 97 Gear
 98 Gear
 99 Gear
 100 Gear

Illustration 43-A Gearbox

Gearbox

1. Gear
2. Gasket
3. Shim
4. Circlip
5. Inner race
6. Outer race
7. Shim
8. Input shaft
9. Sleeve
10. Seal
11. Circlip
12. Inner ring
13. Shim
14. Inner ring
15. Shim
16. Circlip
17. Ball bearing
18. Roller bearing
19. Circlip
20. Needle bearing
21. Gear, 3rd
22. Selector fork, 3rd—4th
23. Output shaft
24. Gear, 2nd
25. Needle bearing
26. Selector fork, 1st—2nd
27. Engaging sleeve, 1st—2nd
28. Hub, 1st—2nd
29. Spring
30. Cone
31. Gear, 1st
32. Circlip
33. Reverse gear
34. Ball bearing
35. Shim
36. Circlip
37. Shim
38. Seals
39. Inner race
40. Inner race
41. Nut
42. Gear
43. Wear ring
44. Rear cover
45. Outer race
46. Inner race
47. Gasket
48. Inner housing
49. Needle bearing
50. Intermediate shaft
51. Gasket
52. 3rd gear
53. Circlip
54. Outer housing
55. Hub, 3rd—4th

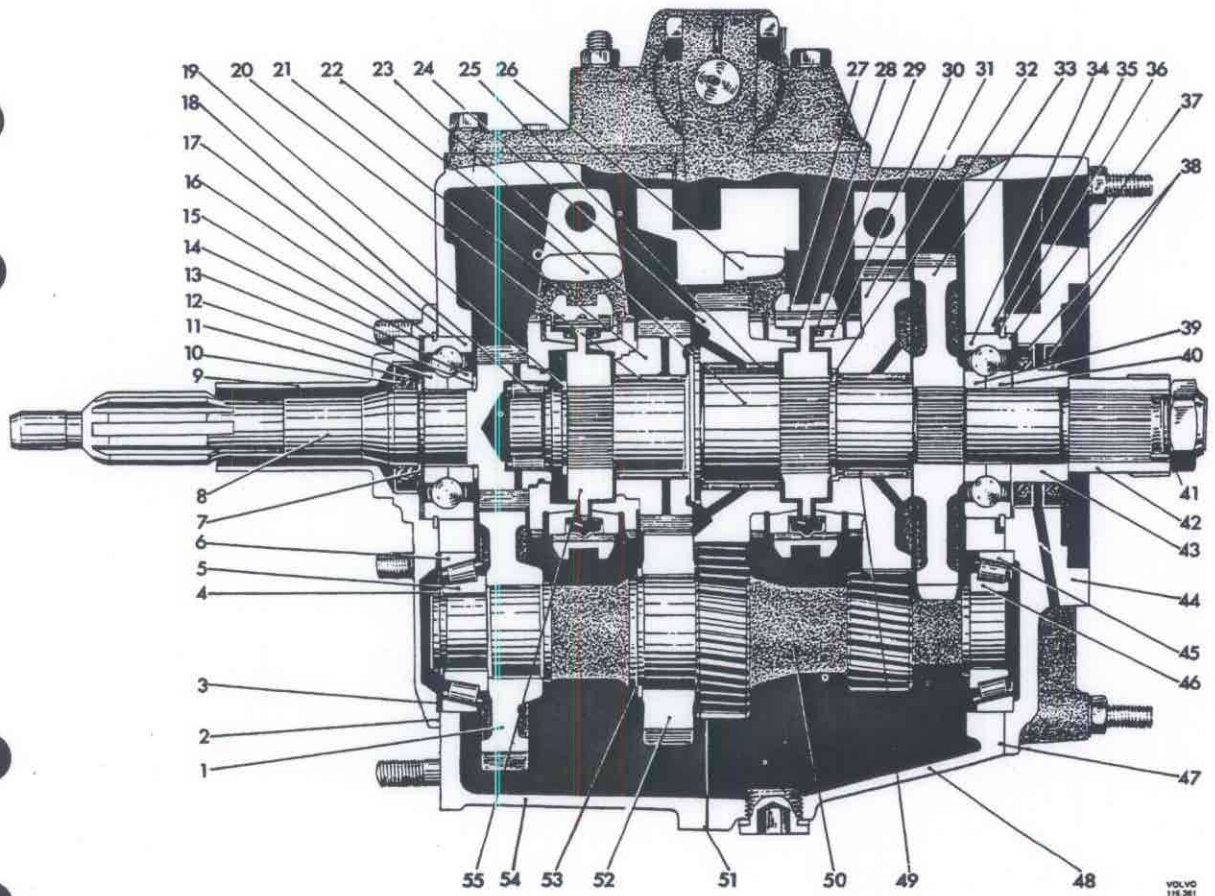

- 1. Gear
- 2. Gear
- 3. Gear
- 4. Gear
- 5. Gear
- 6. Gear
- 7. Gear
- 8. Gear
- 9. Gear
- 10. Gear
- 11. Gear
- 12. Gear
- 13. Gear
- 14. Gear
- 15. Gear
- 16. Gear
- 17. Gear
- 18. Gear
- 19. Gear
- 20. Gear
- 21. Gear
- 22. Gear
- 23. Gear
- 24. Gear
- 25. Gear
- 26. Gear
- 27. Gear
- 28. Gear
- 29. Gear
- 30. Gear
- 31. Gear
- 32. Gear
- 33. Gear
- 34. Gear
- 35. Gear
- 36. Gear
- 37. Gear
- 38. Gear
- 39. Gear
- 40. Gear
- 41. Gear
- 42. Gear
- 43. Gear
- 44. Gear
- 45. Gear
- 46. Gear
- 47. Gear
- 48. Gear
- 49. Gear
- 50. Gear
- 51. Gear
- 52. Gear
- 53. Gear
- 54. Gear
- 55. Gear
- 56. Gear
- 57. Gear
- 58. Gear
- 59. Gear
- 60. Gear
- 61. Gear
- 62. Gear
- 63. Gear
- 64. Gear
- 65. Gear
- 66. Gear
- 67. Gear
- 68. Gear
- 69. Gear
- 70. Gear
- 71. Gear
- 72. Gear
- 73. Gear
- 74. Gear
- 75. Gear
- 76. Gear
- 77. Gear
- 78. Gear
- 79. Gear
- 80. Gear
- 81. Gear
- 82. Gear
- 83. Gear
- 84. Gear
- 85. Gear
- 86. Gear
- 87. Gear
- 88. Gear
- 89. Gear
- 90. Gear
- 91. Gear
- 92. Gear
- 93. Gear
- 94. Gear
- 95. Gear
- 96. Gear
- 97. Gear
- 98. Gear
- 99. Gear
- 100. Gear

Illustration 43-B. Gearbox

Gearbox

1. Dowel
2. Selector fork, 3rd—4th
3. O-ring
4. Bearing pin, 3rd—4th
5. Washer
6. Bolt
7. Gear shift bar
8. Circlip
9. Gear shift bar
10. Shift fork, 1st—2nd
11. Bearing pin, 1st—2nd
12. Lever
13. Circlip
14. Washer
15. Seal
16. Bushing
17. Tubular pin
18. Shift fork, reverse
19. Bearing pin, reverse
20. Case
21. Seal
22. Seal
23. Bushing
24. Seal
25. Bushing
26. Inhibitor
27. Gasket
28. Selector shaft housing
29. Selector shaft
30. Inhibitor shaft
31. Spacer tube
32. Spring
33. Washer
34. Spacer tube
35. Spring
36. Washer
37. Circlip
38. Circlip
39. Pin
40. Selector shaft
41. Outer selector shaft housing
42. Reverse light contact
43. Sealing ring
44. Plug
45. Housing, outer
46. Ball
47. Spring
48. Pin
49. Seal
50. Rear cover
51. Seal
52. Shim
53. Gasket
54. Housing, inner
55. Bolt
56. Washer
57. Cover
58. Gasket
59. Plug
60. Washer
61. Gasket
62. Inhex bolt

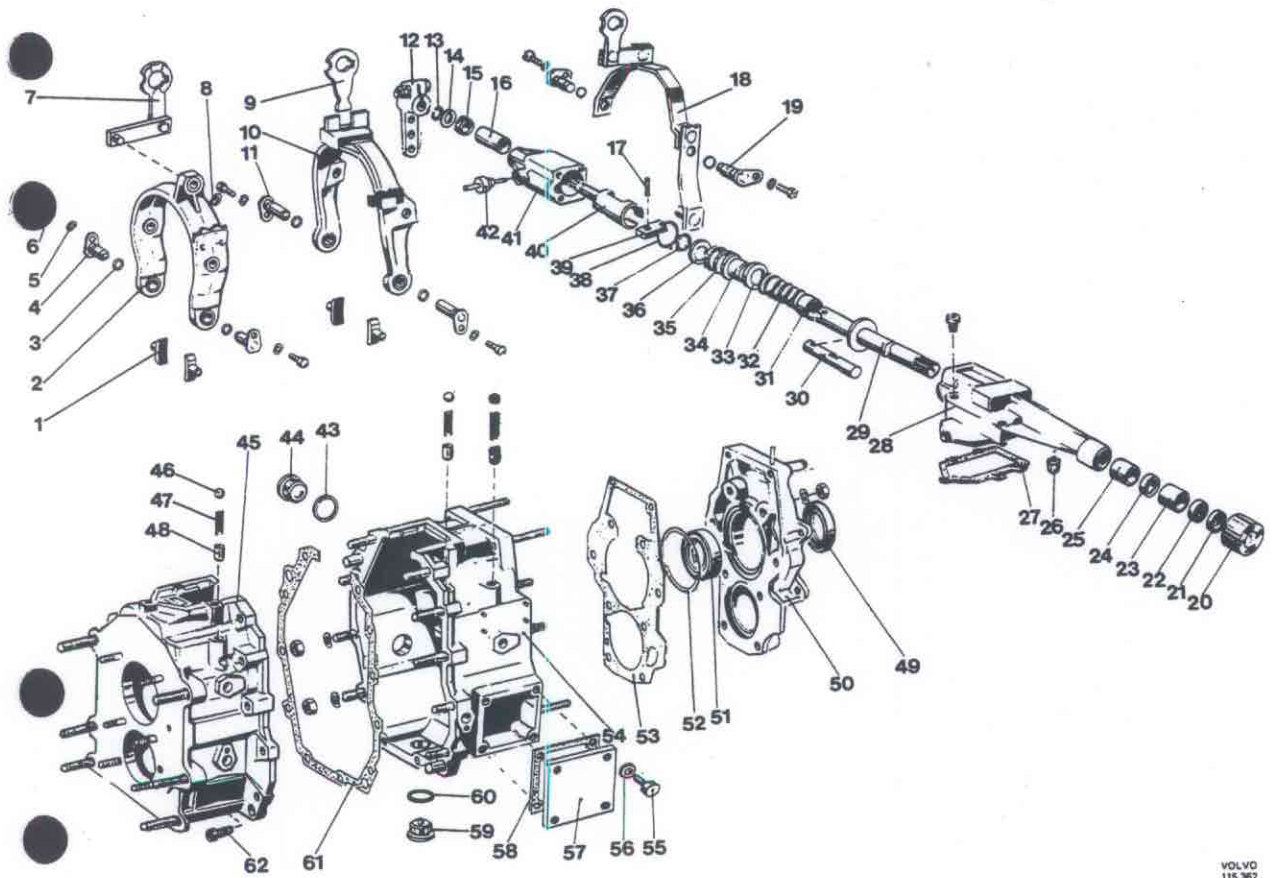



- 21. Gearbox
- 22. Gearbox cover
- 23. Gearbox cover gasket
- 24. Gearbox cover bolt
- 25. Gearbox cover nut
- 26. Gearbox cover washer
- 27. Gearbox cover seal
- 28. Gearbox cover O-ring
- 29. Gearbox cover O-ring
- 30. Gearbox cover O-ring
- 31. Gearbox cover O-ring
- 32. Gearbox cover O-ring
- 33. Gearbox cover O-ring
- 34. Gearbox cover O-ring
- 35. Gearbox cover O-ring
- 36. Gearbox cover O-ring
- 37. Gearbox cover O-ring
- 38. Gearbox cover O-ring
- 39. Gearbox cover O-ring
- 40. Gearbox cover O-ring
- 41. Gearbox cover O-ring
- 42. Gearbox cover O-ring
- 43. Gearbox cover O-ring
- 44. Gearbox cover O-ring
- 45. Gearbox cover O-ring
- 46. Gearbox cover O-ring
- 47. Gearbox cover O-ring
- 48. Gearbox cover O-ring
- 49. Gearbox cover O-ring
- 50. Gearbox cover O-ring
- 51. Gearbox cover O-ring
- 52. Gearbox cover O-ring
- 53. Gearbox cover O-ring
- 54. Gearbox cover O-ring
- 55. Gearbox cover O-ring
- 56. Gearbox cover O-ring
- 57. Gearbox cover O-ring
- 58. Gearbox cover O-ring
- 59. Gearbox cover O-ring
- 60. Gearbox cover O-ring
- 61. Gearbox cover O-ring
- 62. Gearbox cover O-ring
- 63. Gearbox cover O-ring
- 64. Gearbox cover O-ring
- 65. Gearbox cover O-ring
- 66. Gearbox cover O-ring
- 67. Gearbox cover O-ring
- 68. Gearbox cover O-ring
- 69. Gearbox cover O-ring
- 70. Gearbox cover O-ring
- 71. Gearbox cover O-ring
- 72. Gearbox cover O-ring
- 73. Gearbox cover O-ring
- 74. Gearbox cover O-ring
- 75. Gearbox cover O-ring
- 76. Gearbox cover O-ring
- 77. Gearbox cover O-ring
- 78. Gearbox cover O-ring
- 79. Gearbox cover O-ring
- 80. Gearbox cover O-ring
- 81. Gearbox cover O-ring
- 82. Gearbox cover O-ring
- 83. Gearbox cover O-ring
- 84. Gearbox cover O-ring
- 85. Gearbox cover O-ring
- 86. Gearbox cover O-ring
- 87. Gearbox cover O-ring
- 88. Gearbox cover O-ring
- 89. Gearbox cover O-ring
- 90. Gearbox cover O-ring
- 91. Gearbox cover O-ring
- 92. Gearbox cover O-ring
- 93. Gearbox cover O-ring
- 94. Gearbox cover O-ring
- 95. Gearbox cover O-ring
- 96. Gearbox cover O-ring
- 97. Gearbox cover O-ring
- 98. Gearbox cover O-ring
- 99. Gearbox cover O-ring
- 100. Gearbox cover O-ring

Illustration 43-C.Gearbox

Gearbox

50. Front cover
51. Gasket
52. Sleeve
53. Seal
54. Circlip
55. Shim
56. Shim
57. Circlip
58. Inner ring
59. Bearing
60. Shim
61. Input shaft
62. Roller bearing
63. Circlip
64. Synchronizing cone
65. Spring
66. Inhibitor
67. Hub
68. Engaging sleeve
69. 3rd gear
70. Needle bearing
71. Output shaft
72. 2nd gear
73. Needle bearing
74. Cone
75. Hub
76. Engaging sleeve
77. Lock ring
78. 1st gear
79. Needle bearing
80. Reverse
81. Shim
82. Circlip
83. Shim
84. Wear ring
85. Drive
86. Nut
87. Circlip
88. Shim
89. Outer ring
90. Bearing
91. Drive gear
92. Circlip
93. 3rd gear
94. Intermediate shaft
95. Bearing
96. Outer ring
97. Gear
98. Reverse shaft

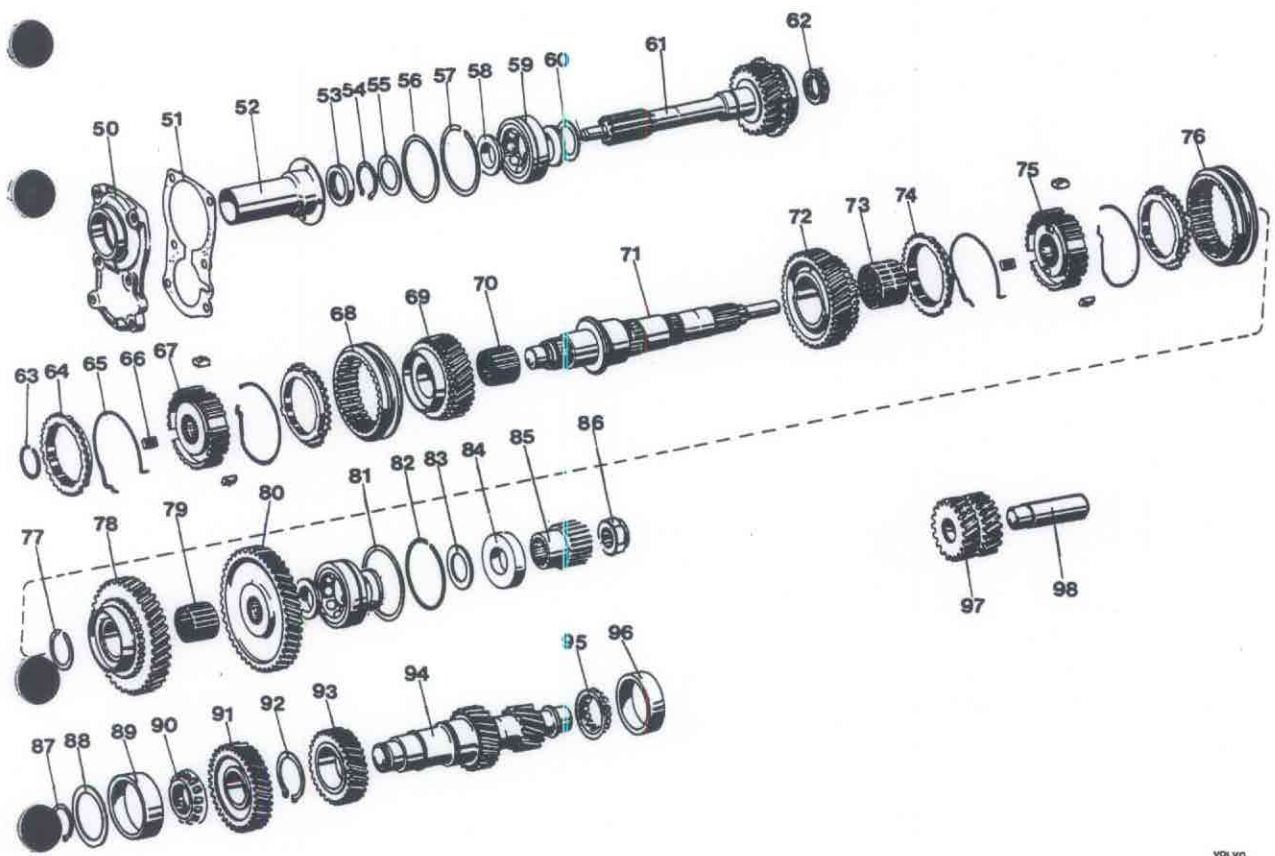

1. Input shaft
 2. Input gear
 3. Output gear
 4. Output shaft
 5. Housing
 6. Lubrication system
 7. Cooling system
 8. Control system
 9. Mounting system
 10. Sealing system
 11. Inspection system
 12. Maintenance system
 13. Safety system
 14. Identification system
 15. Documentation system
 16. Training system
 17. Support system
 18. Spare parts system
 19. Quality control system
 20. Environmental protection system
 21. Noise reduction system
 22. Vibration control system
 23. Temperature control system
 24. Humidity control system
 25. Air quality control system
 26. Water quality control system
 27. Power supply system
 28. Control panel system
 29. Alarm system
 30. Emergency stop system
 31. Interlocking system
 32. Safety interlocking system
 33. Emergency release system
 34. Manual override system
 35. Remote control system
 36. Data logging system
 37. Diagnostic system
 38. Monitoring system
 39. Control system
 40. Protection system

Illustration 43-D. Auxiliary gearbox

Auxiliary gearbox

1. Flange
2. Flange seal
3. Seal
4. Output shaft
5. Ball bearing
6. Housing
7. Flange
8. Shift fork
9. Roller bearing, inner race
10. Needle bearing
11. Hub
12. Cone
13. Engaging sleeve
14. Inhibitor
15. Housing
16. Spring
17. Gear, low-speed
18. Shims
19. Housing
20. Seal
21. Flange seal
22. Flange
23. Speedometer gear
24. Speedometer spindle
25. Roller bearing, inner race
26. Roller bearing, outer race
27. Washer
28. Needle bearing
29. O-ring
30. Roller bearing, inner race
31. Roller, bearing outer race
32. Spacer washer
33. Circlip
34. Ball bearing
35. Drive gear
36. Ball bearing
37. Roller bearing, inner race
38. Roller bearing, inner race
39. O-ring
40. Shaft
41. Shims
42. Gear, high-speed
43. Roller bearing, outer race
44. Circlip
45. Circlip